

INSTRUCTIONS



Page 1 of 2



99TA516049B (for RCD use only)

Instruction Sheet Number: **99TA516049B**

Description: OIL PUMP AND BEARING HEAD ASSEMBLY

Author: G.D.

Date: October 2, 2012

Part Number: 06EA660157

Kit Contents:

<u>Description</u>	<u>Part Number</u>	<u>Qty.</u>
Pump End Bearing Head Assembly	06EA402273	1
Oil Guide Retainer Spring	6D40-1112	1
Oil Guide Feed Vane	6D40-1171	1
Drive Segment, Oil Pump	05KA404093	1
Socket Hd. Capscrew #10-32x1/2" Lg.	AB44AA126	1
Spring Lockwasher #10	AU61ML131	1
Pump End Cover Plate	7J1-6002	1
Gasket, Pump End Cover Plate	6D40-1061	1
Gasket, Sensor Block	06DA680063	1
Capscrew, Socket Hd. 5/16-18 x 7/8" Lg.	AA06GR199	4
Gasket, Capscrew 5/16"	AU51YA003	4
Pump End Brg. Head Gasket	06EA501513	1
Capscrew, Socket Head 1/4-28x5/8" Lg.	AB44AA167	1
Spring Lockwasher 1/4"	AU61ML171	1
Pipe Plug, 1/4"	CA63AS051	1
Instruction Sheet	99TA516049	1
Label	LF680001	1
Gasket, Sensor block	06DA504473	1

BEARING HEAD-OIL PUMP ASSEMBLY REPLACEMENT PROCEDURE

Important: To install the new bearing head-oil pump, it is necessary to first isolate the compressor from the rest of the system and properly reclaim any refrigerant (as required by the environmental regulations) from the compressor.

REMOVING BEARING HEAD

1. Remove the cover plate from the bearing head assembly by removing the four 5/16" head cap screws. **THERE IS SPRING TENSION BEHIND THE COVER PLATE.**
2. Remove the spring and guide vane.
3. Remove the two allen head cap screws and lock washers that attach the drive mechanism to the crankshaft.
4. Remove the eight 7/16" hex head bolts from the bearing head and pull the bearing head off the crankshaft and away from the crankcase housing. Remove and discard the old gasket.

INSTALLING BEARING HEAD

1. Attach the bearing head assembly and bearing head gasket to the crankcase housing. Torque the bolts to 55-60 ft./lb.



DRIVE SEGMENT WITH SNORKEL

FIGURE 1

2. Attach the drive mechanism, Fig. 3, (with the snorkel tube protruding out away from the crankshaft) to the crankshaft. Torque the bolts to 4-6 ft./lbs. For the No. 10 screw and 12-15 ft./lbs. For the ¼ inch screw.

CAUTION: DO NOT INSTALL THE DRIVE MECHANISM WITH THE SNORKEL INSERTED INTO THE CRANKSHAFT. IT CAN RESTRICT OIL FLOW INTO THE OIL PUMP.

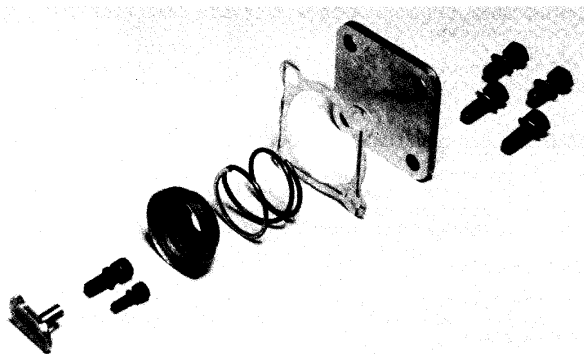

Figure 2

3. Install the oil fed guide vane, spring, cover plate gasket and cover plate to the bearing head as shown in Figure 2. (Drive segment with snorkel and attaching screws also pictured). Torque the bolts to 16-20 ft./lbs.

NOTE: Compressors using the Electronic Lube Oil Control (P/N 06DA660115) will attach the 06EA680078 Sensor Block (not included in this kit) and 06DA680063 Sensor Block Gasket in place of the Cover Plate and Cover Plate Gasket pictured in Figure 2.

CAUTION: DO NOT OVER-TORQUE THESE BOLTS; THE BEARING HEAD IS ALUMINUM.