

Service Manual

Ventilating Fan
(North America Market)

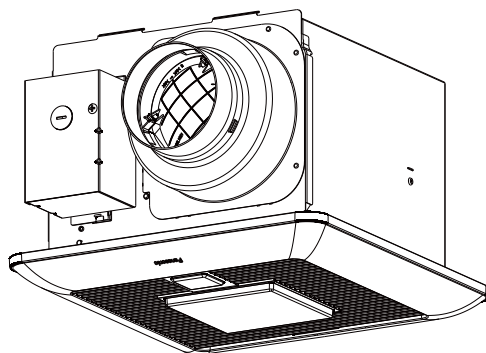

FV-0511VQCL1

⚠ WARNING

This service information is designed for experienced repair technicians only and is not designed for use by the general public. It does not contain warnings or cautions to advise non-technical individuals of potential dangers in attempting to service a product. Products powered by electricity should be serviced or repaired only by experienced professional technicians. Any attempt to service or repair the product or products dealt with in this service information by anyone else could result in serious injury or death.

IMPORTANT SAFETY NOTICE

There are special components used in this equipment which are important for safety. These parts are marked by ⚠ in the Schematic Diagrams, Exploded Views and Replacement Parts List. It is essential that these critical parts should be replaced with manufacturer's specified parts to prevent shock, fire or other hazards. Do not modify the original design without the manufacturer's approval.

Please have a static electricity depletion process in place before handling these components..

Please use gloves when handling PCB parts during the repair process..

| CONTENTS | PAGE |
|------------------------------|-------|
| 1.Specification | 1 |
| 2.Parts Identification | 2 ~ 4 |
| 3.Wiring Diagram | 5 |
| 4.Parts List | 6 ~ 7 |

1. Specification

| Model No. | Air direction | Voltage (V) | Frequency (Hz) | Duct diameter (Inches) | Air volume at 0.1"WG (CFM) | Noise (sones) | Speed (rpm) | Power (W) | Weight lb. (kg) |
|--------------|---------------|-------------|----------------|------------------------|----------------------------|---------------|-------------|-----------|-----------------|
| FV-0511VQCL1 | Exhaust | 120 | 60 | 4 or 6 | 50 | < 0.3 | 768 | 4.0 | 10.1 (4.6) |
| | | | | | 80 | < 0.3 | 867 | 6.1 | |
| | | | | | 110 | 0.4 | 1016 | 11.0 | |

HVI Certified performance based on HVI Procedures 915, 916, and 920.

Remark: We divide this model into Version A & Version B, because of different motor and Main PCB Section, please put attention with identification of parts when you request a service parts.

Parts for Version A

Motor

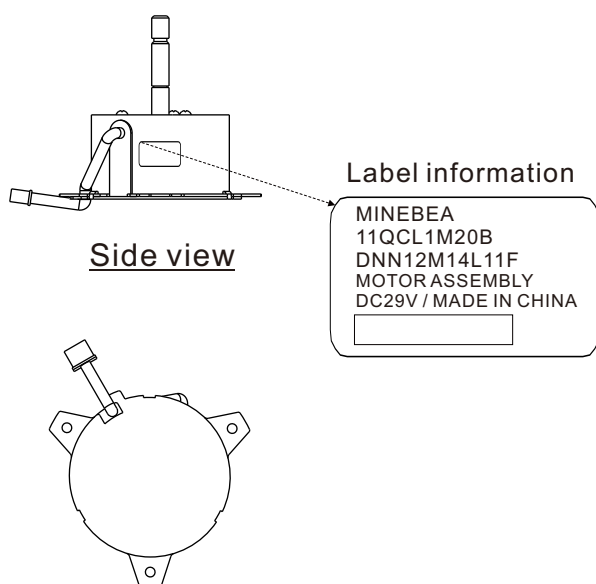

Main PCB Section

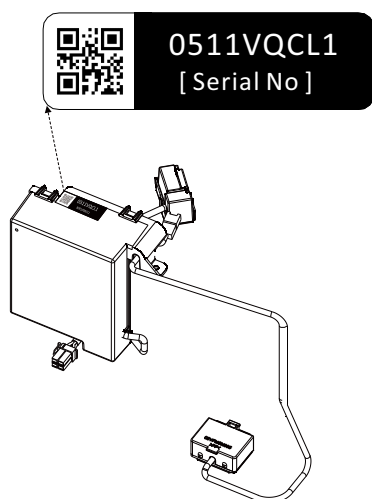

Parts for Version B

Motor

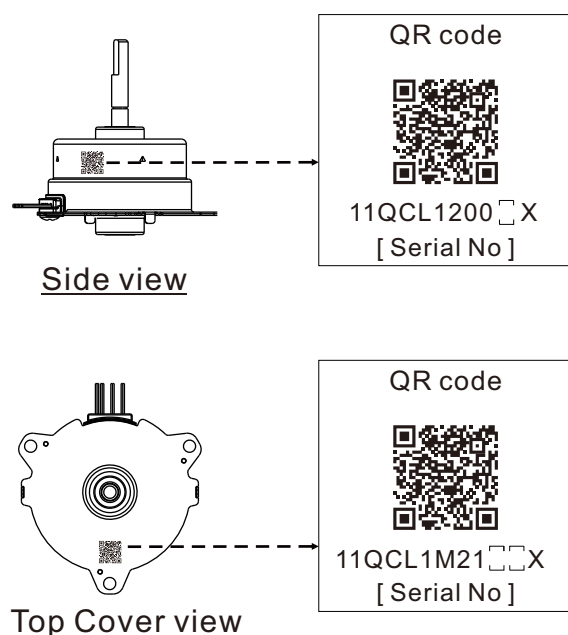

Main PCB Section

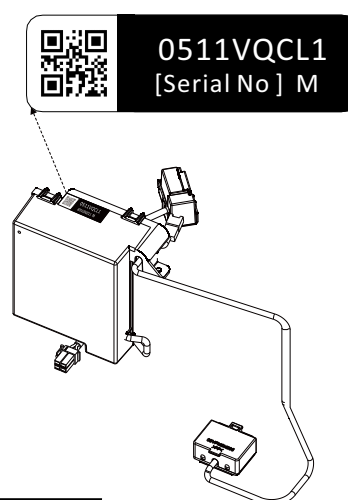

| Motor | Main PCB | Judgment |
|-----------|-----------|--------------------|
| Version A | Version A | (OK) Work |
| Version A | Version B | (NG) Do Not Work |
| Version B | Version B | (OK) Work |
| Version B | Version A | (NG) Do Not Work |

2. Parts Identification

FV-0511VQCL1

Main Body Section

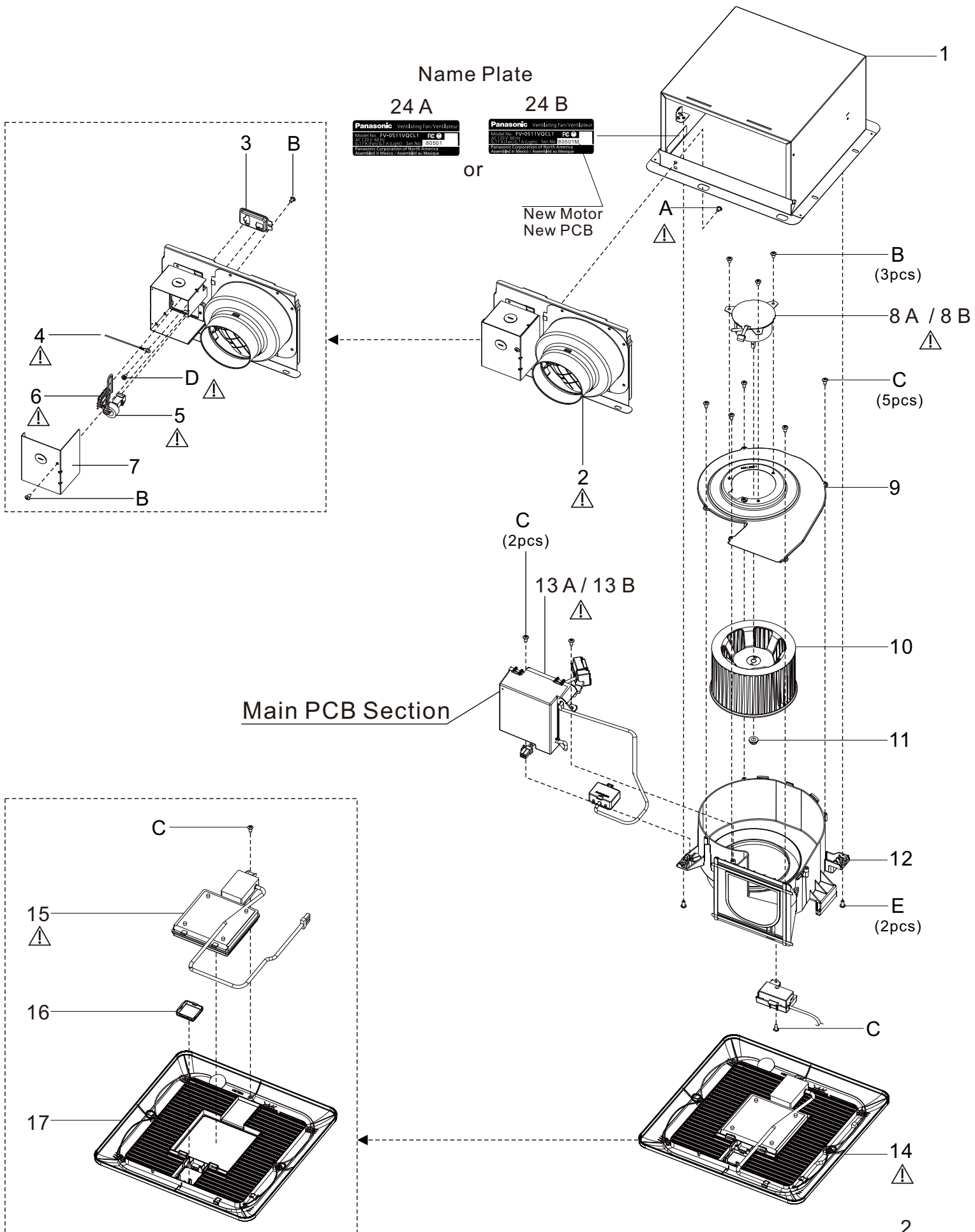

2. Parts Identification

FV-0511VQCL1

Main PCB Section

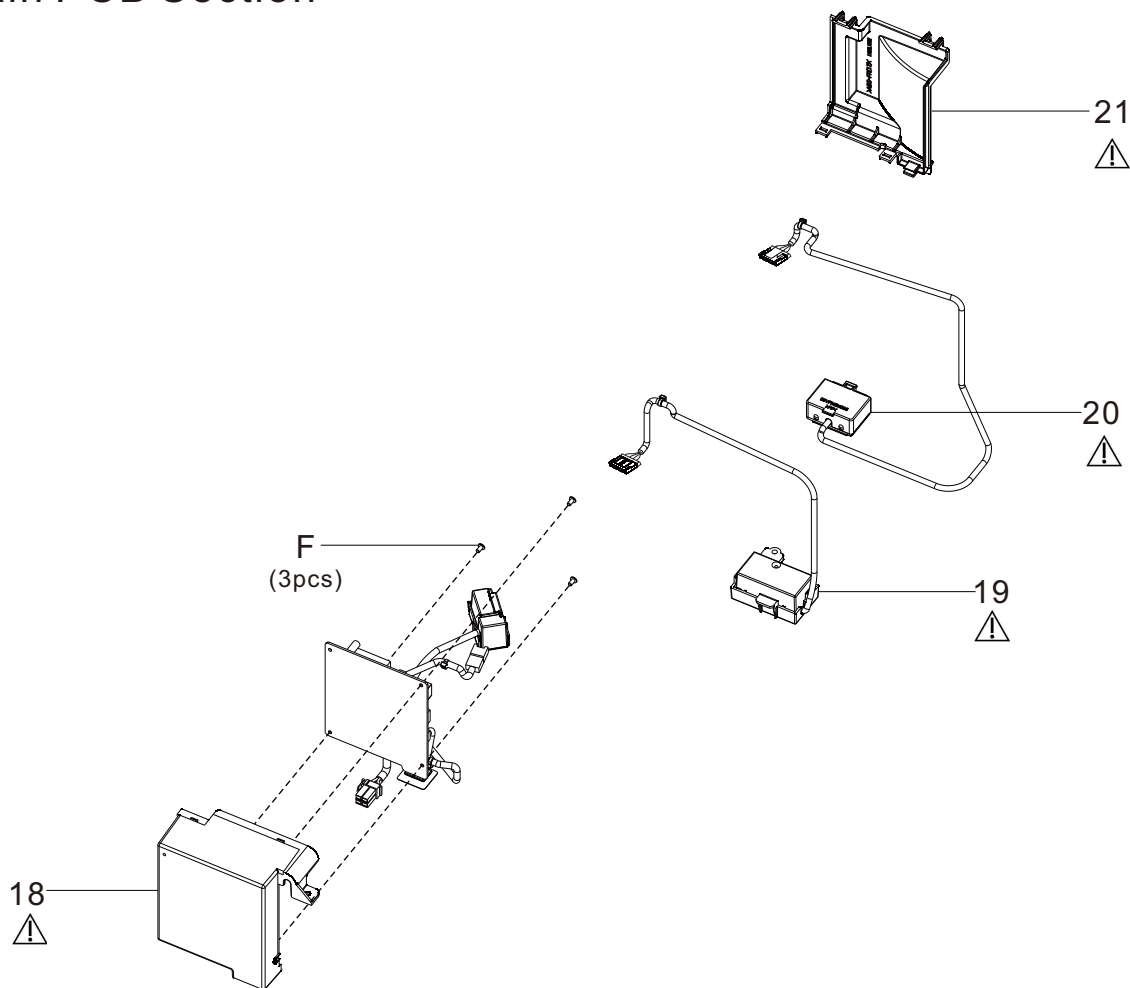

Main Label



WARNING:
1. Before service or cleaning unit, switch power off at service panel and lock service panel to prevent power from being switched on accidentally.
2. Acceptable for use over a bathtub or shower when installed in a GFCI protected branch circuit.
CAUTION:
To reduce the risk of injury to persons, install fan at least 2.1m (7 feet) above the floor.
ATTENTION:
1. Pour l'entretien ou le nettoyage, mettre l'appareil hors tension au niveau de la façade des commandes et du panneau de verrouillage des commandes afin d'éviter toute mise sous tension accidentelle.
2. Convient pour utilisation au-dessus d'une baignoire ou d'une douche si raccordé à un circuit de dérivation protégé aux normes GFCI.
3. Afin de réduire les risques de blessures corporelles, installer le ventilateur à au moins 2.1m (7 pieds) du sol.

Part for Version A



8 Means Year: 2018
05 Means Month
01 Means Day

Part for Version B



8 Means Year: 2018
05 Means Month
01 Means Day
M: In House MOTOR



For grounding, please keep the screw firmly
Pour la mise à la terre veuillez visser fermement

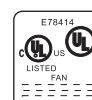

2. Parts Identification

FV-0511VQCL1

Packing Section

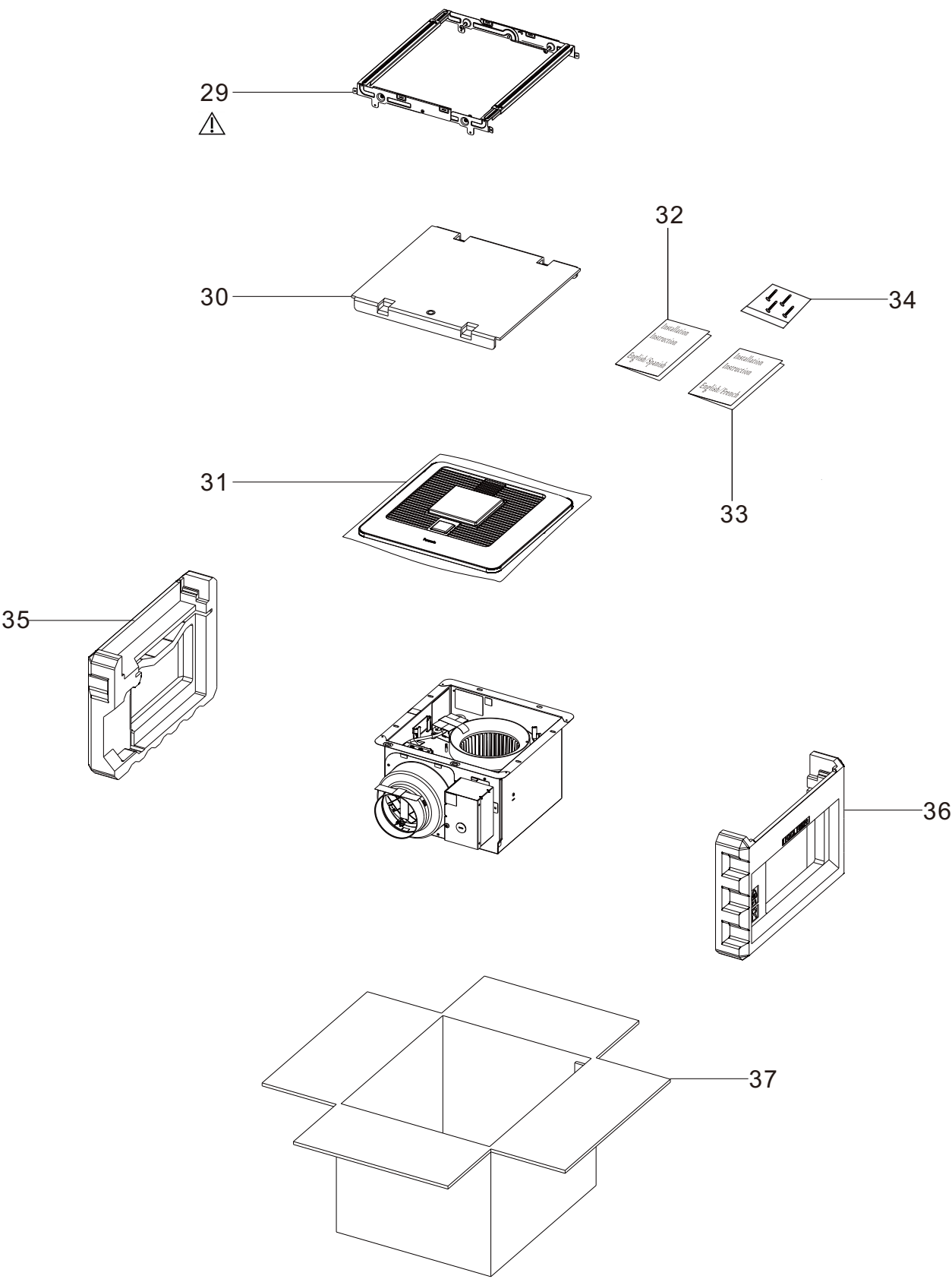

3.Wiring Diagram

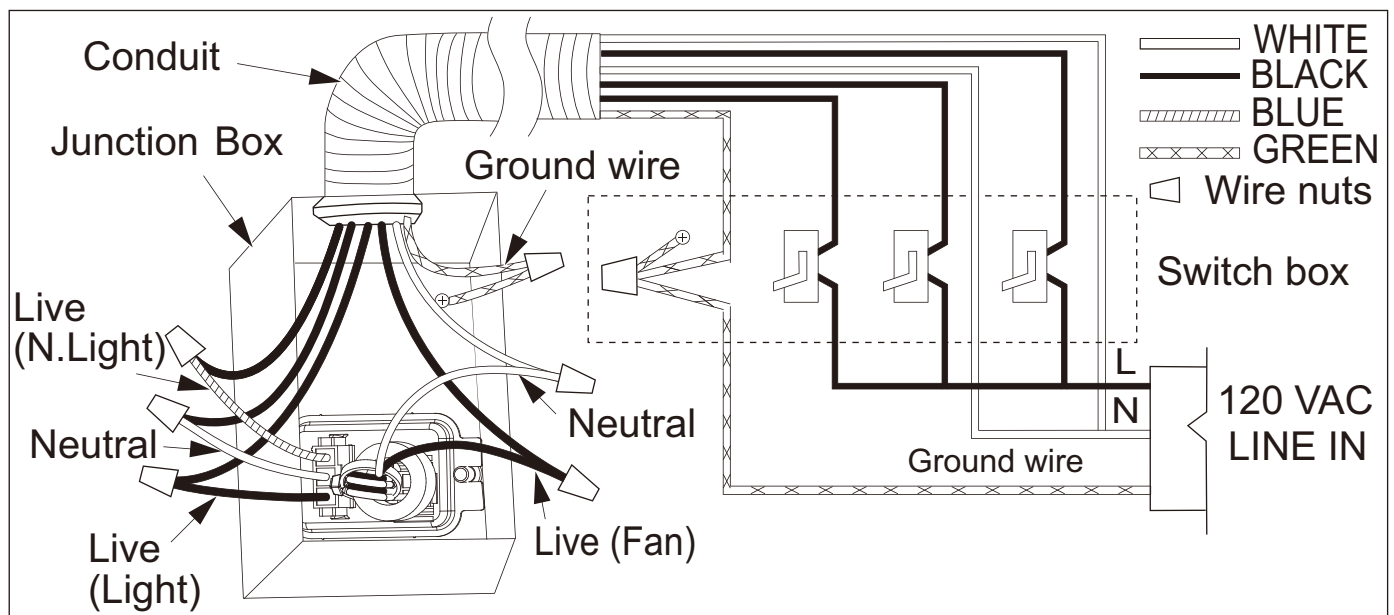
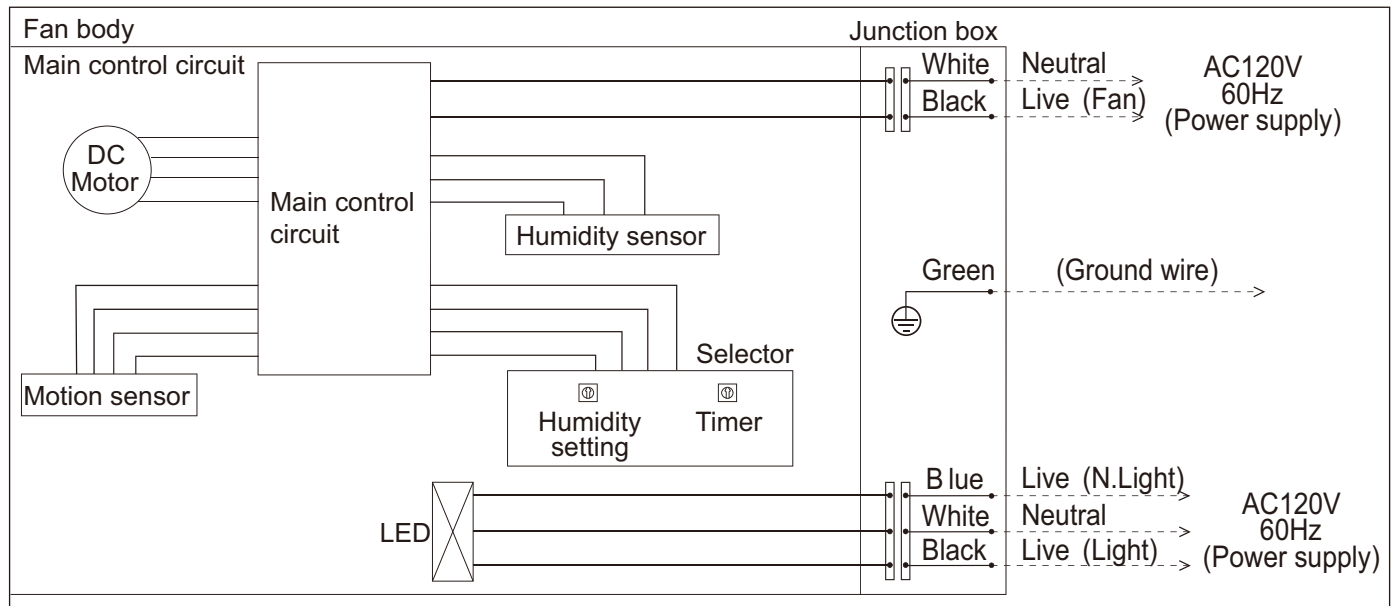

4. Parts List

FV-0511VQCL1

Main Body Section

| No. | Part No. | Part Name | Q'ty | Remark |
|-----|------------------|----------------------|------|-------------|
| 1 | FFV11QCL1900C | Frame Assembly | 1 | |
| 2 | FFV11QCL1910 | Adapter Assembly | 1 | ⚠ |
| 3 | FFV11QCL1913 | Connector Plate | 1 | |
| 4 | FFV11QCL1331 | Ground Wire | 1 | ⚠ |
| 5 | FFV11QCL1301A | Connector Assy | 1 | ⚠ |
| 6 | FFV11QCL1341A | Connector Assy (L) | 1 | ⚠ |
| 7 | FFV11QCL1912A | Junction Cover | 1 | |
| 8A | FFV11QCL1M20A | Motor | 1 | Version A ⚠ |
| 8B | FFV11QCL1M21AX | Motor | 1 | Version B ⚠ |
| 9 | FFV11QCL1904C | Motor Support Assy | 1 | |
| 10 | FFV0400114S | Blade | 1 | |
| 11 | FFV7020021S | Nut | 1 | |
| 12 | FFV11QCL1906B | Casing Section | 1 | |
| 13A | FFV0511VQCL1UPCB | Main PCB section | 1 | Version A ⚠ |
| 13B | FFV11VQCL1PCB | Main PCB section | 1 | Version B ⚠ |
| 14 | FFV0511VQCL1A | Grill Assembly | 1 | |
| 15 | FFV3400148S | Led Unit | 1 | ⚠ |
| 16 | FFV13KML3996C | Sensor Cover | 1 | |
| 17 | FFV0511VQCL1S | Grill Section | 1 | |
| A | FFVXYM4-E8FJ | Screw (M4-8) | 1 | ⚠ |
| B | FFVXTT4-8FFJ | Screw (ST4-8) | 5 | |
| C | FFV7000089S | Screw (ST4-12) | 9 | |
| D | FFVXYM4DC8BN | Screw w/washer(M4-8) | 1 | ⚠ |
| E | FFV7000065S | Screw (M4-12) | 2 | |

Main PCB Section

| No. | Part No. | Part Name | Q'ty | Remark |
|-----|---------------|------------------|------|--------|
| 18 | FFV11QCL1991D | Main PCB Box | 1 | ⚠ |
| 19 | FFV11QCL1560 | S.W PCB Assy Set | 1 | ⚠ |
| 20 | FFV11QCL1540 | Motion Sensor | 1 | ⚠ |
| 21 | FFV11QCL1992C | Main PCB Cover | 1 | ⚠ |
| F | FFVXTN3-8GFJ | Screw (M3-8) | 3 | |

4. Parts List

FV-0511VQCL1

Main Label

| No. | Part No. | Part Name | Q'ty | Remark |
|-----|---------------|-----------------|------|-----------|
| 22 | FFV11QCL1011A | Switch Label | 1 | |
| 23 | FFV11QCL1012A | CFM Label | 1 | |
| 24A | FFV11QCL1050 | Name Plate | 1 | Version A |
| 24B | FFV11QCL1050M | Name Plate | 1 | Version B |
| 25 | FFV0810011S | Caution Label 1 | 1 | |
| 26 | FFV0810010S | Caution Label | 1 | |
| 27 | FFV6730045S | Warning Label | 1 | |
| 28 | FFV2260003S | Holograph Label | 1 | |

Packing Section

| No. | Part No. | Part Name | Q'ty | Remark |
|-----|----------------|-------------------|------|---|
| 29 | FFV11QCL1920 | Hanger Assy | 1 |  |
| 30 | FFV4710381S | Grill Pad Assy | 1 | |
| 31 | FFV4650016S | Poly Cover | 1 | |
| 32 | FFV11QCL1420B | Installation Inst | 1 | English / Spanish For USA Market |
| 33 | FFV11QCL1421 | Installation Inst | 1 | English / French For CANADA Market |
| 34 | FFV11KSL1M031A | Accessory A | 1 | |
| 35 | FFV11QCL1891 | Left Pad | 1 | |
| 36 | FFV11QCL1892 | Right Pad | 1 | |
| 37 | FFV11QCL1400B | Packing Case Assy | 1 | |