



# SUBMITTAL MicroMetl

WEIGHT:  
125 lbs

DATE:  
8/10

Part Number:  
**CA-CAR-SDCL-CAR-5894**

SUBMITTED TO: \_\_\_\_\_ JOB NAME: \_\_\_\_\_  
COMPANY: \_\_\_\_\_ EQUIPMENT: \_\_\_\_\_  
DRAWN BY: \_\_\_\_\_ NOTES: \_\_\_\_\_

## NEW CARRIER UNITS (CAR-SDCL)

48/50VL,ES,EZ A42-A60; 48/50VT,XL,XT A36-060

## EXISTING UNIT (CAR-5894)

**CARRIER:** 48HX 030-060; 48SS 018-060; 48SX 024-060  
**BRYANT:** 588A 018-060; 589A 024-060; 658A 030-060

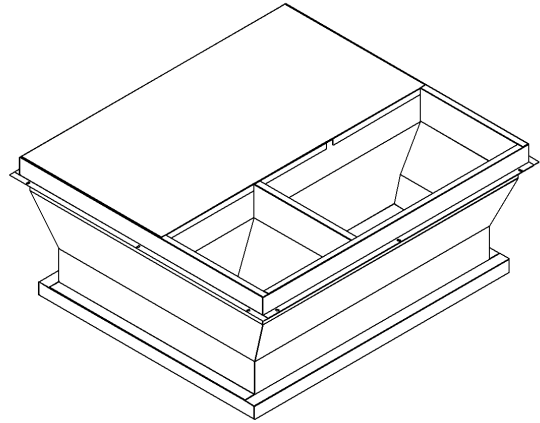
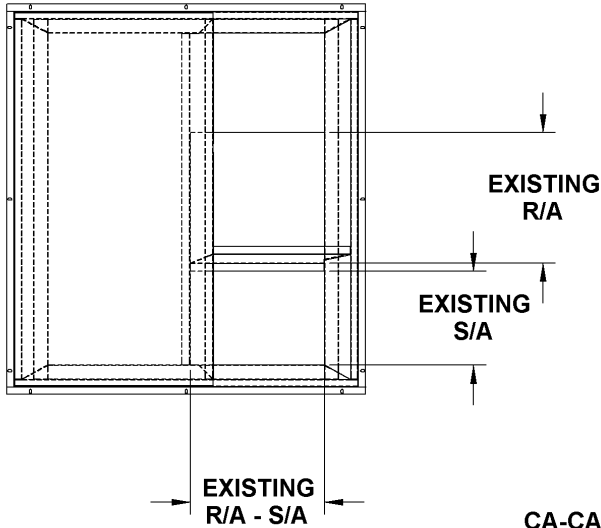

CA-CAR-SDCL-CAR-5894

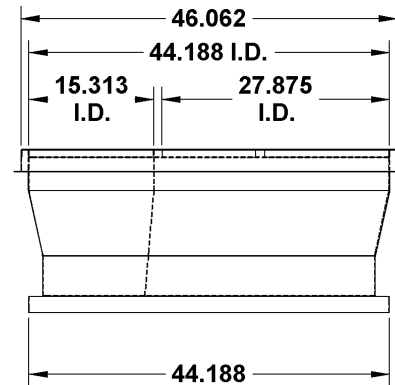
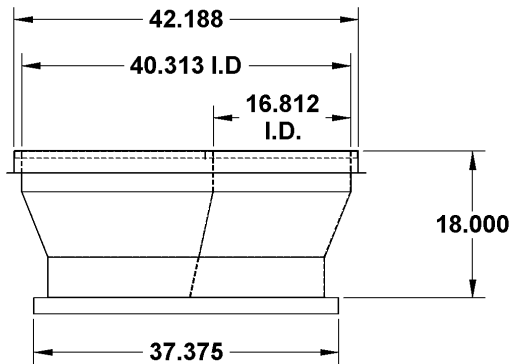

### Features:

- Fully assembled curb adaptor.
- Includes internal duct transitions.
- Internally insulated with 1" - 1.5" lb insulation. Gasketing package provided.
- Adaptor pans and supports provided / field installed

### Curb Adaptor Information

- To verify that the curb adaptor shown on this page is the correct adaptor for your job be sure the existing curb is the same size as the dimensions provided. (The bottom dimensions of curb adaptor are larger than existing curb outside dimension.)
- Before new HVAC unit is set in place, inspect structural stability of existing curb and building's roof load capability. Reinforce if required.
- All curb adaptors will increase the systems external static pressure and must be included when calculating unit requirements.
- Curb adaptors are designed to attach to an existing curb with side x side duct connections. The curb adaptor is not designed for use with concentric duct configuration.
- No calculations are available for this product. For a calculated product, please contact factory for part number, pricing, and lead time.
- Please contact factory for more detailed dimensional information if required. Designs are based on standard factory dimensions, and may differ in the field.

THIS DOCUMENT IS THE PROPERTY OF MICROMETL CORPORATION AND IS DELIVERED UPON THE EXPRESS CONDITION THAT THE CONTENTS WILL NOT BE DISCLOSED OR USED WITHOUT MICROMETL'S WRITTEN CONSENT

FORM NO. 8320-1P